

Map Key
 * indicates location of Confederate Veteran grave stone

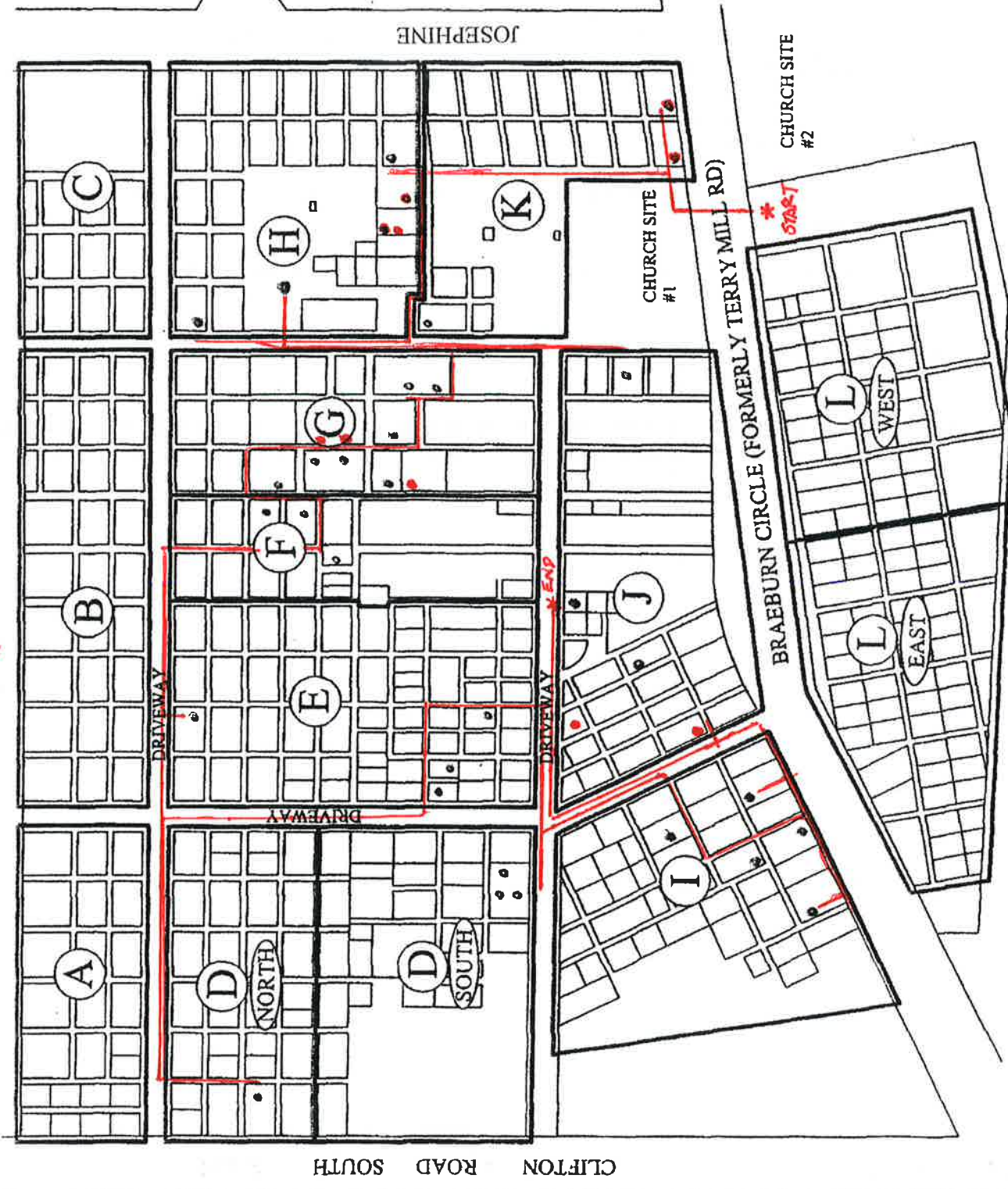

CHURCH SITE #1
 IN THE MID 1800s THIS WAS A ONE ROOM SCHOOLHOUSE DECEDED BY MARY TERRY IN FEBRUARY 1874 TO TRUSTEES FOR SYLVESTER CHAPEL METHODIST EPISCOPAL CHURCH SOUTH. THE CHURCH WAS NAMED AFTER MARY TERRY'S DECEASED SON WHO HAD DIED IN 1872 AT THE AGE OF 15 YEARS. THE METHODIST CHURCH FAILED AND THE SCHOOLHOUSE BECAME KNOWN AS THE SYLVESTER MEETING HOUSE

IN 1883 SYLVESTER BAPTIST CHURCH WAS ORGANIZED AND USED THE MEETING HOUSE AS ITS BUILDING OF WORSHIP UNTIL OUTGROWING THE ORIGINAL ONE ROOM SCHOOLHOUSE IN 1887.

CHURCH SITE #2
 IN JULY OF 1887 THE CONGREGATION MOVED TO THE NEWLY CONSTRUCTED CHURCH BUILDING ACROSS THE ROAD. THIS PROPERTY WAS GIVEN TO THE CHURCH BY EDWARD A. WERNER. IN FEBRUARY OF 1955 A NEW BUILDING WAS DEDICATED AND THE CHURCH REMAINED UNTIL DISSOLVING IN 1972

NASH

JOSEPHINE

CHURCH SITE #1

CHURCH SITE #2

* START

BRAEBURN CIRCLE (FORMERLY TERRY MILL RD)

WEST

EAST

DRIVEWAY

DRIVEWAY

CLIFTON ROAD SOUTH

A

B

C

D NORTH

D SOUTH

E

F

G

H

J

K

L

L

L

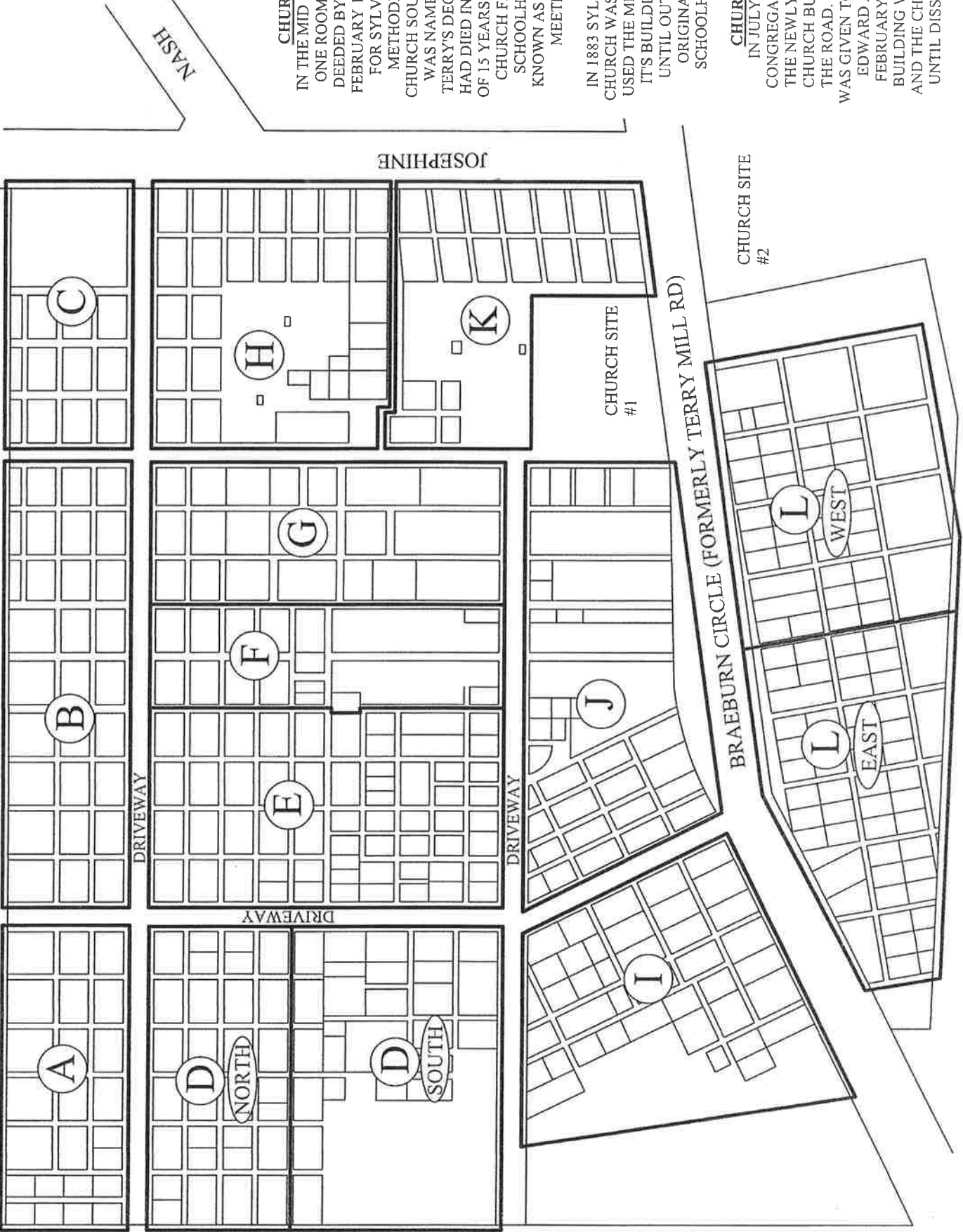

CHURCH SITE #1
 IN THE MID 1800s THIS WAS A ONE ROOM SCHOOLHOUSE DEEDED BY MARY TERRY IN FEBRUARY 1874 TO TRUSTEES FOR SYLVESTER CHAPEL METHODIST EPISCOPAL CHURCH SOUTH. THE CHURCH WAS NAMED AFTER MARY TERRY'S DECEASED SON WHO HAD DIED IN 1872 AT THE AGE OF 15 YEARS. THE METHODIST CHURCH FAILED AND THE SCHOOLHOUSE BECAME KNOWN AS THE SYLVESTER MEETING HOUSE.

IN 1883 SYLVESTER BAPTIST CHURCH WAS ORGANIZED AND USED THE MEETING HOUSE AS IT'S BUILDING OF WORSHIP UNTIL OUTGROWING THE ORIGINAL ONE ROOM SCHOOLHOUSE IN 1887.

CHURCH SITE #2
 IN JULY OF 1887 THE CONGREGATION MOVED TO THE NEWLY CONSTRUCTED CHURCH BUILDING ACROSS THE ROAD. THIS PROPERTY WAS GIVEN TO THE CHURCH BY EDWARD A. WERNER. IN FEBRUARY OF 1955 A NEW BUILDING WAS DEDICATED AND THE CHURCH REMAINED UNTIL DISSOLVING IN 1972.

NASH

JOSEPHINE

CHURCH SITE #2

CHURCH SITE #1

BRAEBURN CIRCLE (FORMERLY TERRY MILL RD)

L WEST

L EAST

CLIFTON ROAD SOUTH

DRIVEWAY

DRIVEWAY

DRIVEWAY

NORTH

SOUTH

A

D

E

F

G

H

K

J

I

L

L

C

B

A

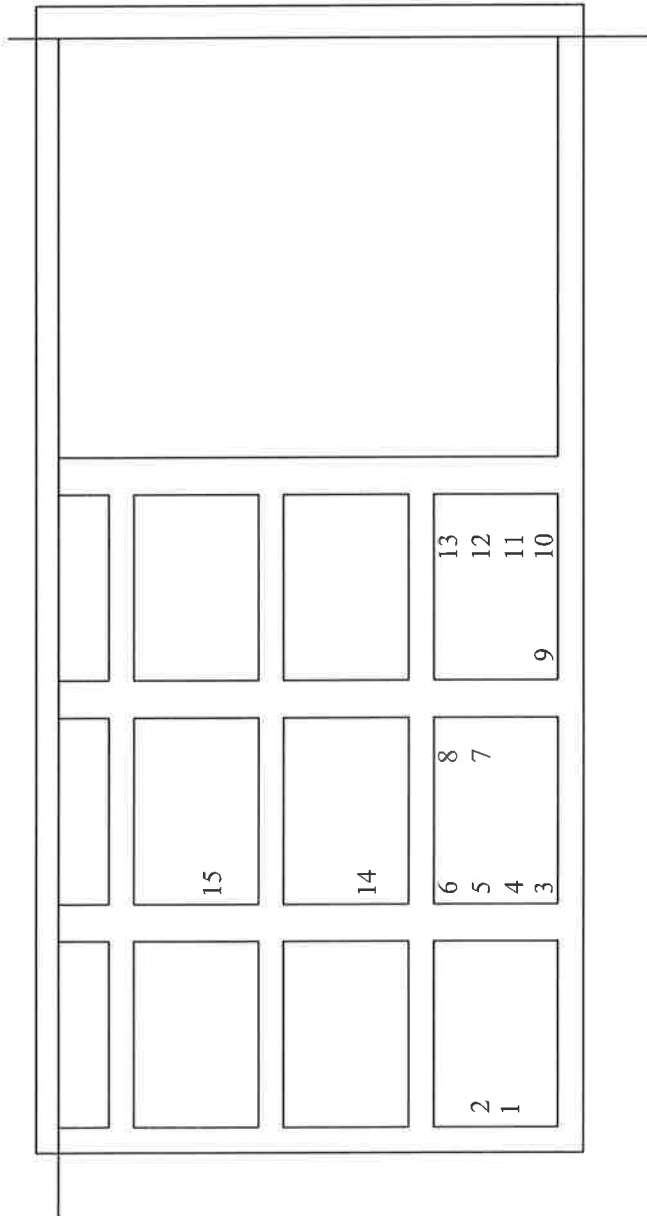

BLOCK C
 SYLVESTER CEMETERY

CLIFTON ROAD SOUTH

4	3	2	1	5	8	11	12.1	15	16
					7	10	12	14	
					6	9		13	
19	18	17	20	25	31		34	39	43
				24	32		35		44
				23	33		36	40	45
				22			37	41	46
				21			38	42	47
									48
75	74	72	73	64			61	60	54
				65			62	58	55
				66				59	56
				67					57
				68					50
									51
									52
									53
76	77	78	79	83	88	90		91	96
				85	89			92	97
				86				93	
				87					

BLOCK D (NORTH) - SYLVESTER CEMETERY

DRIVEWAY

1	98 99 100 101	102 103 104 106 107			149 150 151	152 153 154
6 5				119		
	108 109	110 111			155	156 157 158 159 160
2 3	4A 4					
7 8 9 10 11 12 13	14 15 16	112 114 113 115	120 121	122 123	167	161 162 163 166 164 165
17 18 19 20	21 22 23	116	124 126 127	125	169 170 171 173 168 172 174	
	24 25	117	130		180 181 182 183 184	175 176 177 178 179
	51 50 48 30 29	97 96 92 95 91 94 93	131 132 133 134			
26	45 46	44	137 138 141 139 142 140			
47		43				
40 39 38 37 33 36 32 35 31 34	42 41	85				185 186
60B 60C 60D	58 60A 59 60	61 62 63	143 144 145	146 147		190 187 191 188 191 189
	64 65 66 67 68 69	74 75 73 76 72 77 71 79 70 78	148		193 194 195	192

DRIVEWAY

BLOCK E
SYLVESTER CEMETERY

DRIVEWAY

BLOCK F SYLVESTER CEMETERY

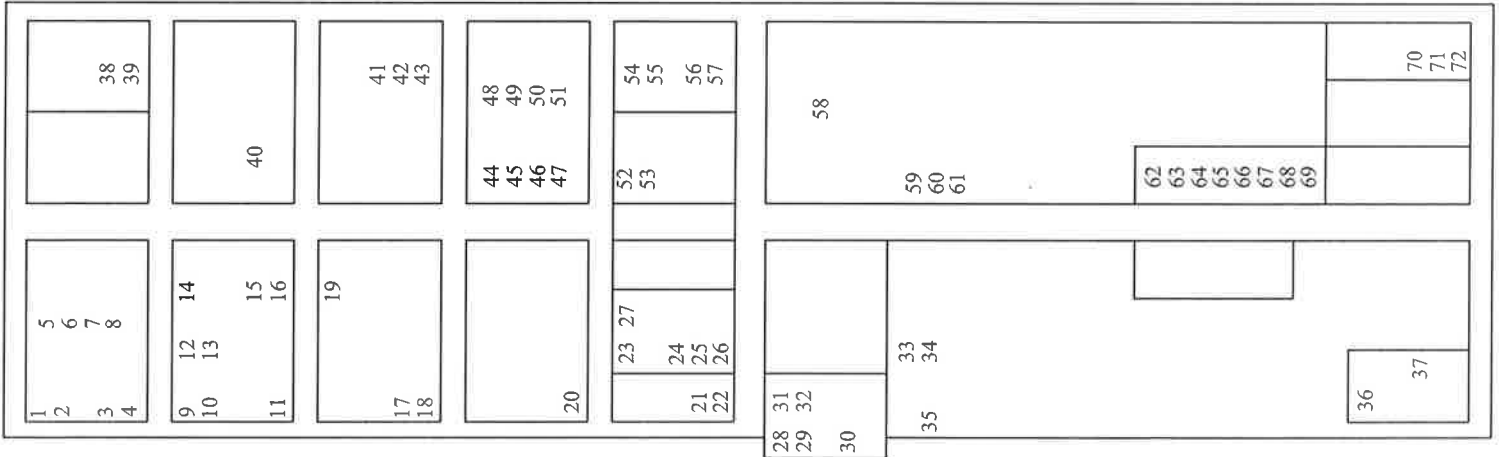

1	42 43	44 45 46	82 83 84
2 3	47 48 49 50	51 52 53	85 86
4 5 6 7	8 9 10	54 55 56 57 58 59 60 61 62 63 64 65 66 67	87 88 89 90 91 92
11 12 13 14 15 16 17 18 19	20 21	68 69 70 71 72	
25 26 27	30	73 74 75 76 77 78 79 80 81	93 94 95 96 97 98 99 100 101 102
32 33 34 35 36	31		103 104 105
37 38 39			106 107 108 109
40 41			

BLOCK G
SYLVESTER CEMETERY

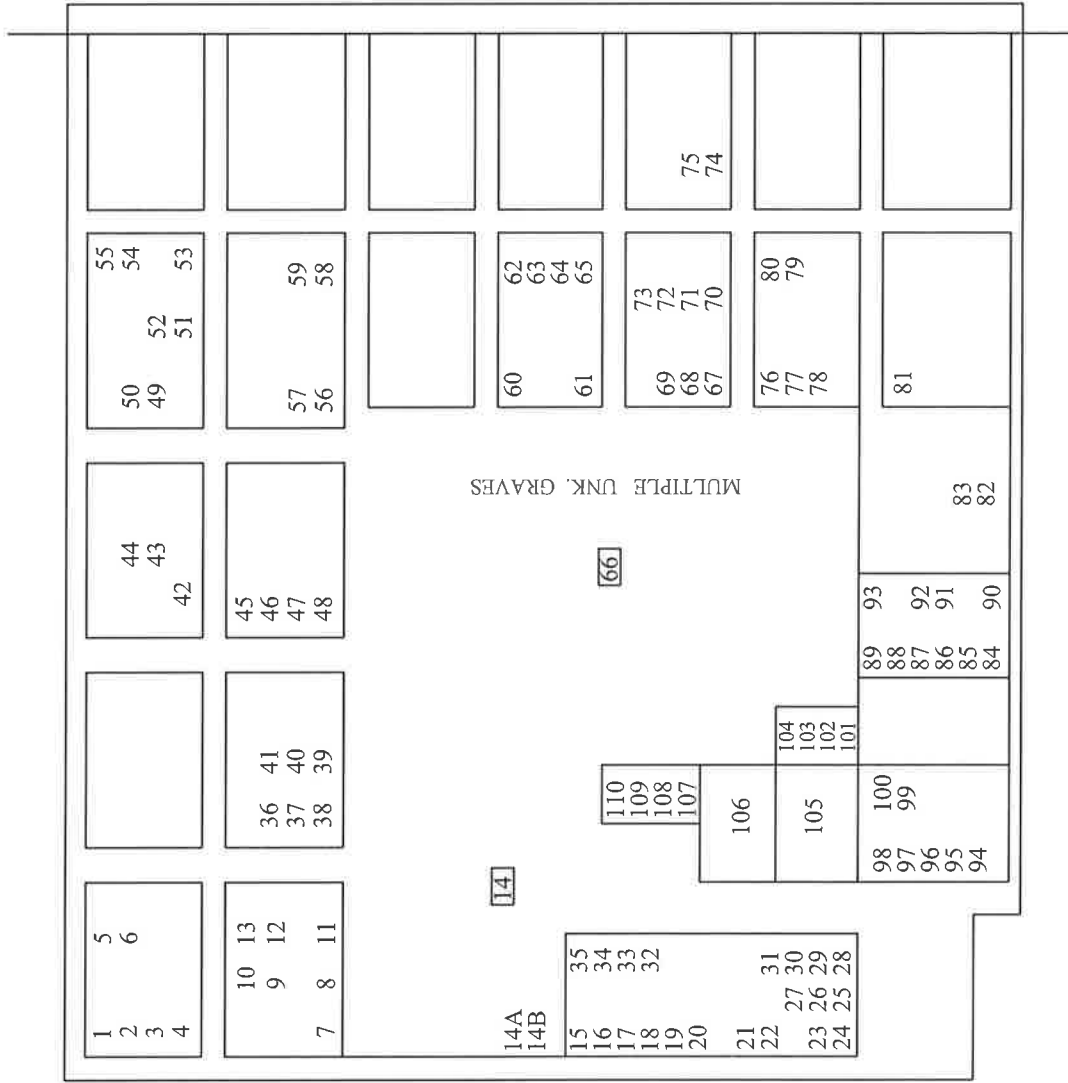

BLOCK H SYLVESTER CEMETERY

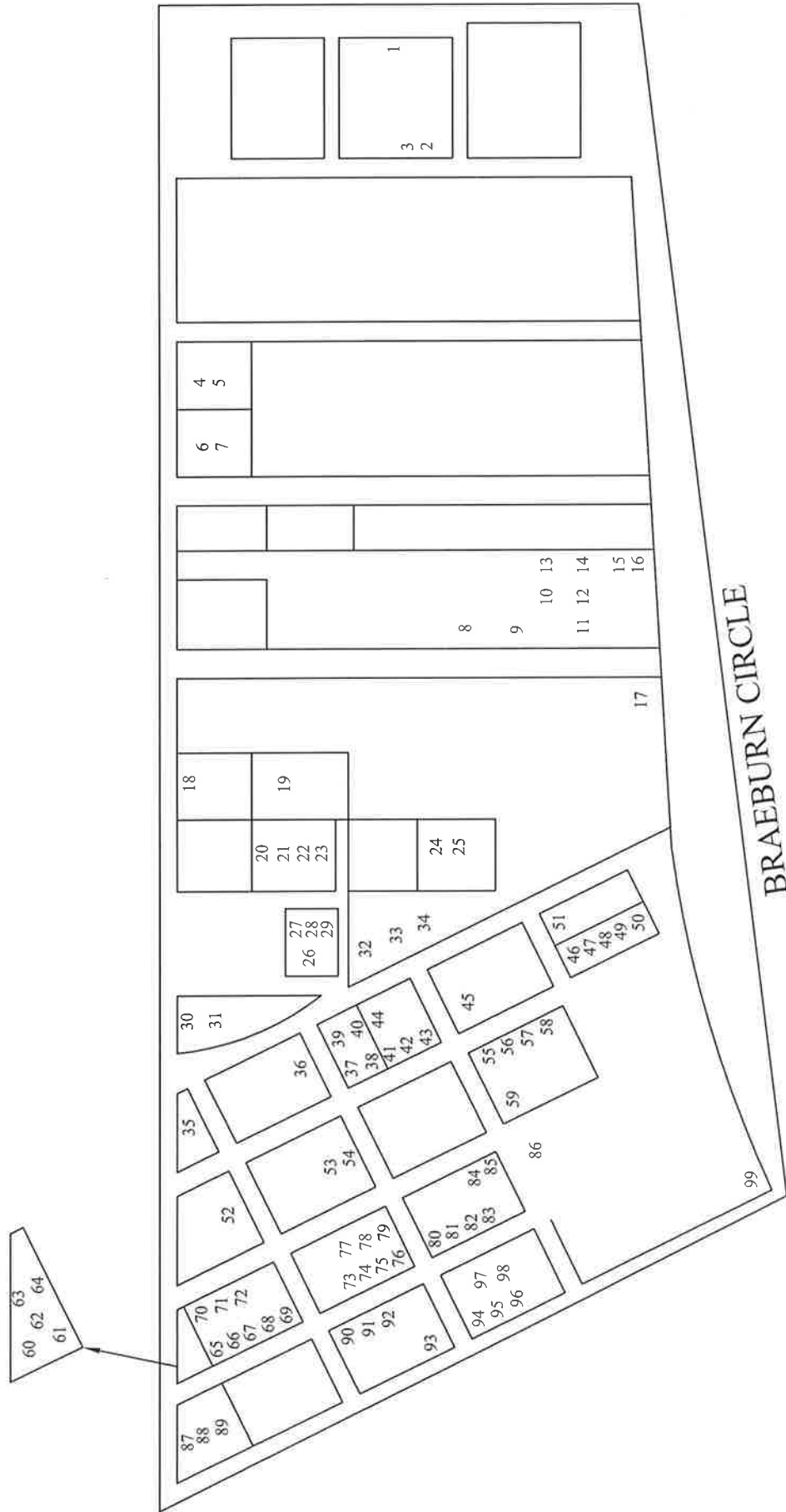

BRAEBURN CIRCLE

BLOCK J
SYLVESTER CEMETERY

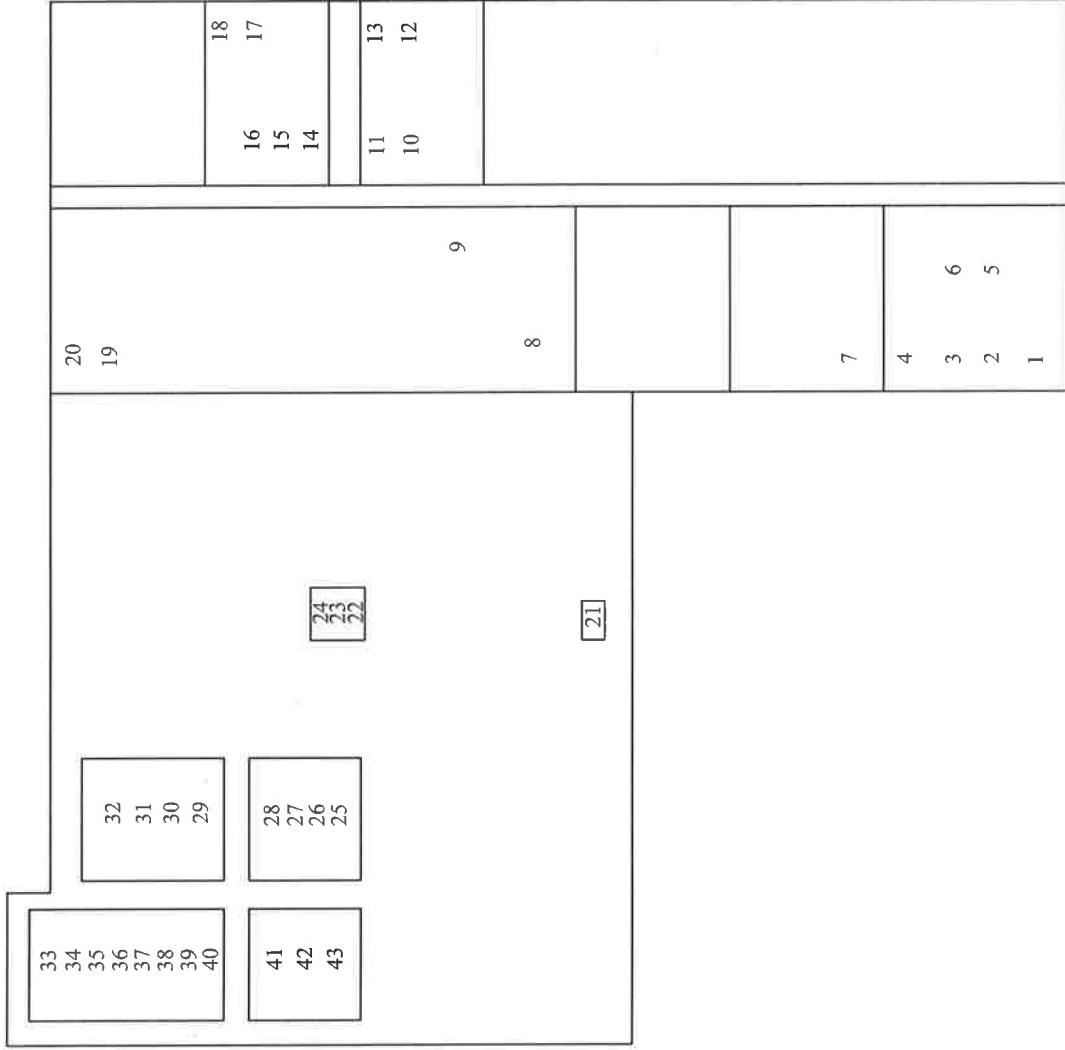

NASH ST

BRAEBURN CIRCLE

BLOCK K
SYLVESTER CEMETERY

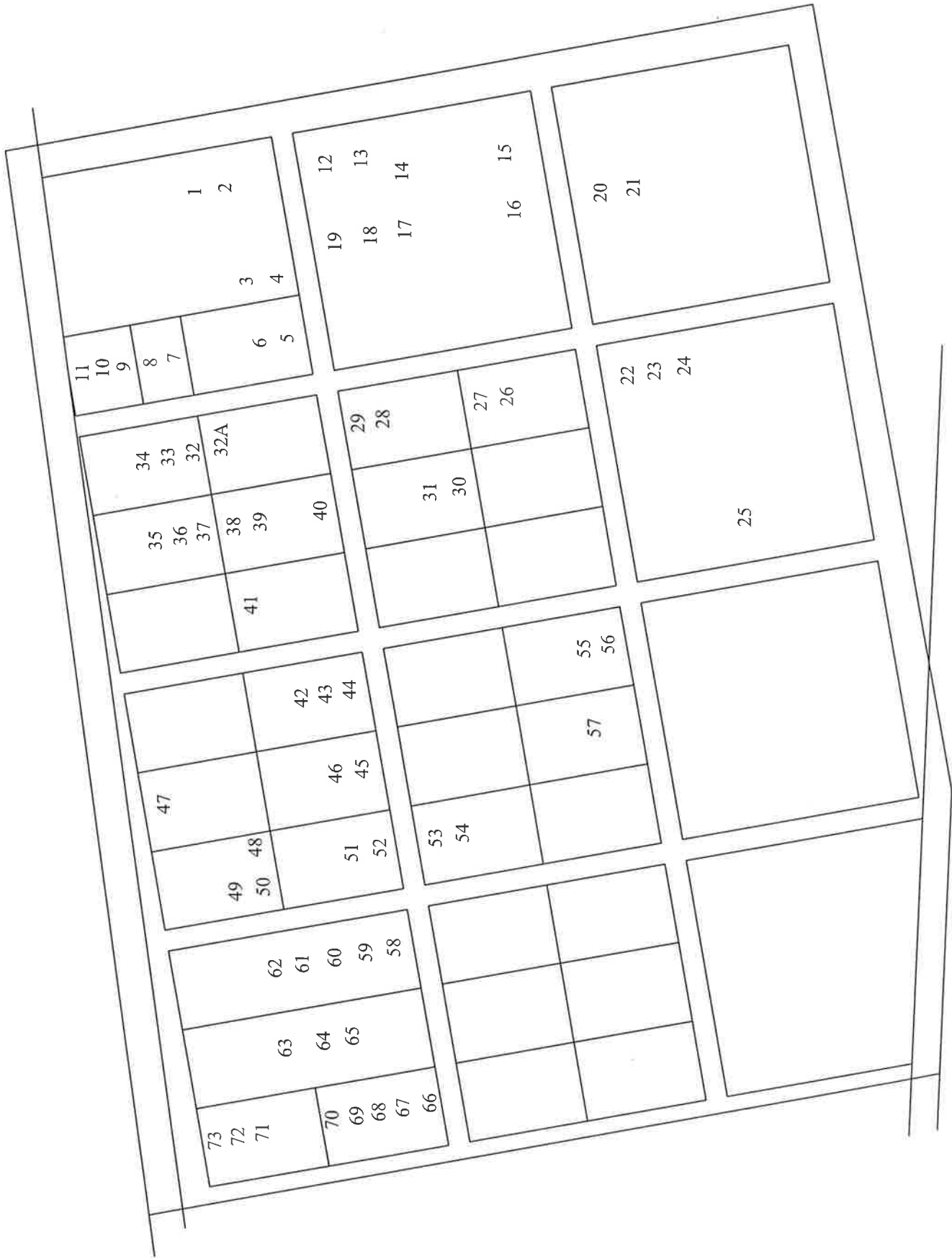

BLOCK L (EAST)- SYLVESTER CEMETERY

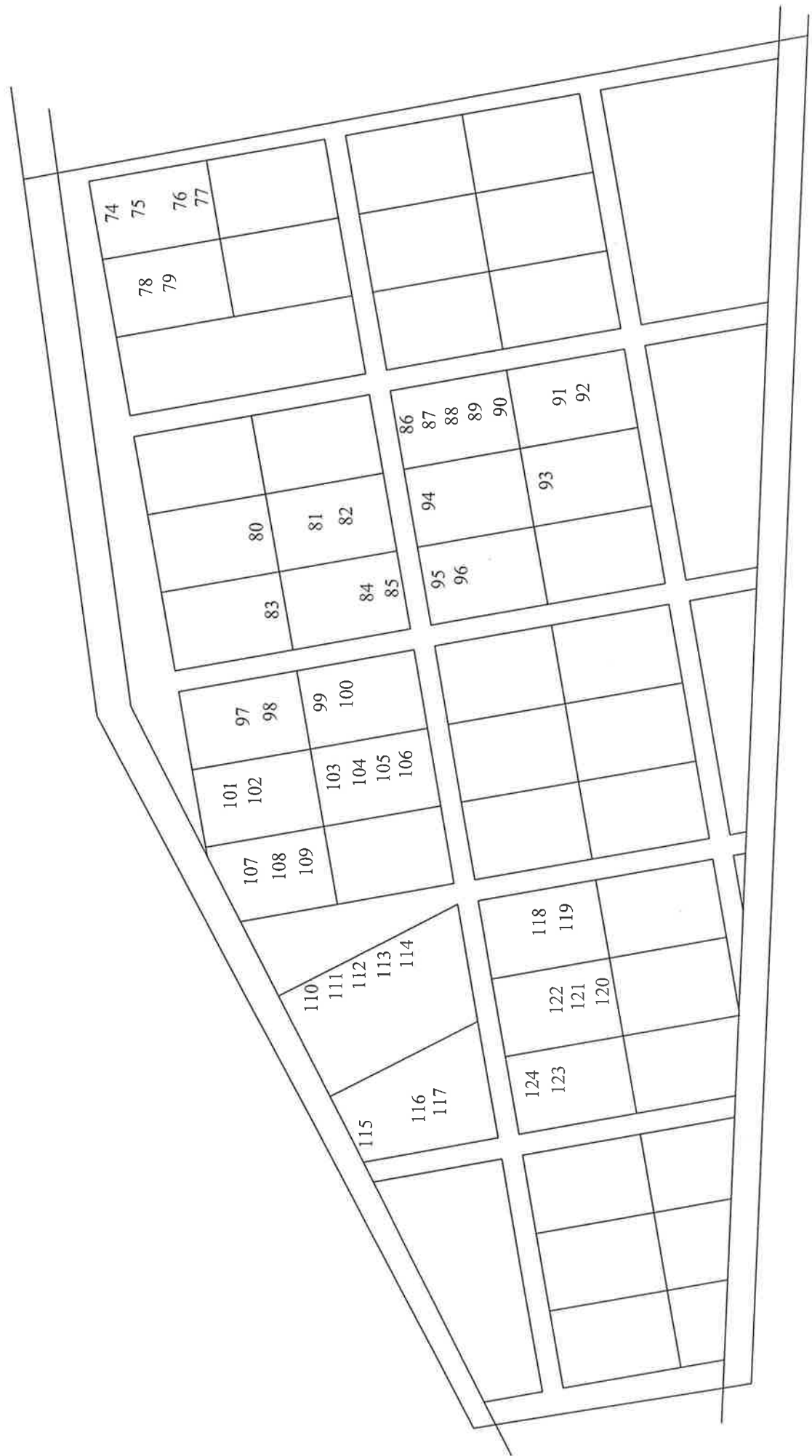

BLOCK L (WEST) - SYLVESTER CEMETERY